

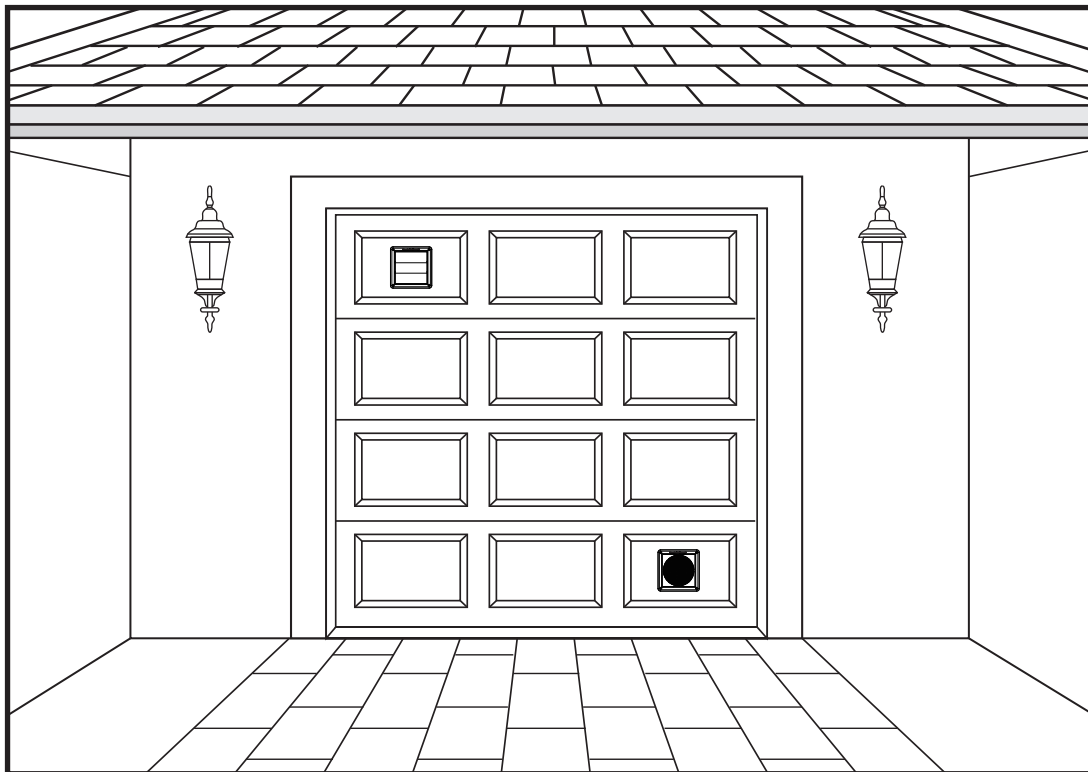

The Vent-A-Garage System

MODEL VG100 - Single Car Garage Door System

The Vent A Garage Draws in Cooler Outside Air while Expelling Hot, Humid Air



WHY VENT A GARAGE?

- **Removes Excess Heat from the Garage** - Reduces Air Conditioning demand by lowering heat from the walls of an attached Garage. Provides a more comfortable work environment. A change you will notice right away!
 - **Reduces Humidity from Garage Interior** - Increases comfort. Reduces moisture and mildew. Reduces rusting of tools and equipment.
 - **Reduces Fumes and Odors** - Greatly reduces Gasoline, Auto exhaust, turpentine, paint thinner, and other vapors from the garage that can be unpleasant and harmful. Also reduces odor from garbage, fertilizer and pesticides.
 - **Maintains Security** - Uses two small holes thru the garage door. No large openings needed for window fans that may provide entrance to intruders.
 - **Energy Efficient** - Uses only 22 watts during operation.
-

Owner's Instructions

Vent-A-Garage System

Model No. : VG100

CAUTION: Read all instructions and warnings before operating!
SAVE THESE INSTRUCTIONS! READ ALL INSTRUCTIONS!



VG100 Parts List

Check the package and make sure all the parts listed below are included

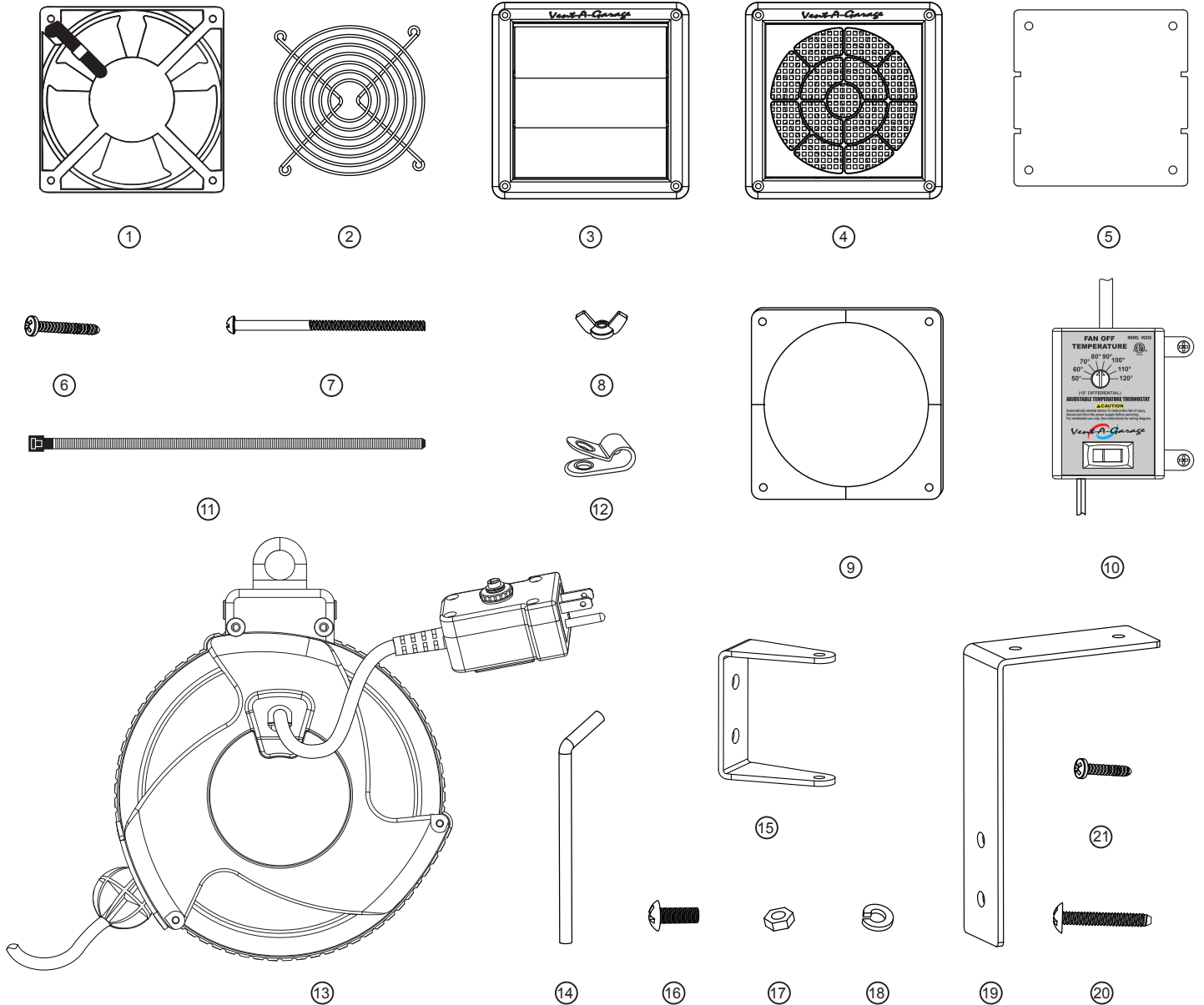

Item No.	Part Name	Description	Qty
1	Fan	120x120x38mm, 120VAC, 60Hz	1
2	Finger Guard	Plated Steel Wire	2
3	Exhaust Cover	Grey, Plastic, Louvered	1
4	Intake Cover	Grey, Plastic, Screen	1
5	Intake Air Blocker	Plastic Sheet, Clear	1
6	Mounting Screw A	Phillips Self-Drilling, #6 x 3/4"	10
7	Fan Mounting Bolt	M4*104mm (2 Fans x 4 Each)	8
8	Wing Nut	M4, Plated Steel (2 Fans x 4 each)	8
9	Template	Grey, plastic	1
10	Thermostat Control Box	Temp. range from 50°F to 120°F	1
11	Cable Tie	Nylon	5

Item No.	Part Name	Description	Qty
12	Wire Clip	Nylon	3
13	Retractable Cord Reel	Yellow, 15Ft, SVT 18/3 Black Cord	1
14	Lock Pin	Plated, Steel	1
15	C Bracket	Plated, Steel	1
16	C Bracket Bolt	1/4" X 1/2" Long Hex Head Bolt	2
17	C Bracket Nut	1/4" Hex Nut	2
18	Lock Washer	Plated Steel, Split Type	2
19	L Bracket	Steel, plated, for ceiling mount	1
20	L Bracket Screw	#8 X 1 1/2" Long Phillips Pan Head	2
21	Mounting Screw B	Phillips Self-Drilling, #6 x 3/8"	8

Owner's Instructions

Vent-A-Garage System

Model No. : VG100

CAUTION: Read all instructions and warnings before operating!
SAVE THESE INSTRUCTIONS! READ ALL INSTRUCTIONS!



WARNING: To avoid serious injury or death from electrical shock or fire.

1. **DO NOT** handle this system or try to plug it in when your hands are wet or when standing on a wet or damp surface.
2. **RISK OF INJURY! Spinning Fan Blades -Do not connect to power until all covers and guards are in place.**
3. This system **MUST ALWAYS BE USED** in accordance with all Electrical and safety codes and ordinances, including the most recent National Electric Code (NEC) and with the Occupational Safety and Health Act (OSHA) Volume 1 on General Industry Standards and Interpretations.
4. **ALWAYS** disconnect the power before servicing or inspecting this system for any reason.
5. This system is **ONLY FOR USE ON** 110-120V circuits that is equipped with approved 3 conductor cord and 3-prong, grounded type plugs.
6. **TO REDUCE THE RISK OF ELECTRICAL SHOCK**, the power cord should only be connected to a properly grounded 3-prong outlet.
7. **THIS SYSTEM IS FOR GARAGE USE ONLY! DO NOT** intended to use in showers, saunas or in potentially wet locations.
8. **DO NOT** use in potentially dangerous locations, such as in flammable or explosive atmospheres.
9. **KEEP OUT OF REACH OF CHILDREN.**

INSTALLATION INSTRUCTIONS

STEP 1

MARK AND CUT HOLES THRU DOOR - (Reference Fig.1)

1. Use the Template (Item #9) to draw the two 4 1/2" vent hole locations on the outside surface of the door. The 2 vent hole locations should be positioned so that the distance to the edge of the door is the same for all. The vent hole locations as shown in Fig.1, are conveniently positioned in the center of the decorative panels of the illustrated door. However, your door may have other panel arrangements or may be flat with no decorative panels.

Caution! Before cutting the vent holes - Stand back and look at the marked hole locations to make sure there are positioned as you like them from a decorative point of view. Check the inside door surface behind the marked vent holes to make sure that no braces or brackets will obstruct the cutting of the marked holes.

2. Use the Template to mark four small holes adjacent to the upper 4 1/2" hole only. Fig 1. shows a typical layout of the hole locations for a typical garage door. These marked holes should then be drilled to 3/16" Diameter. Be careful to drill the holes as close to perpendicular to the door surface as possible. (See inset illustration Fig. 1)

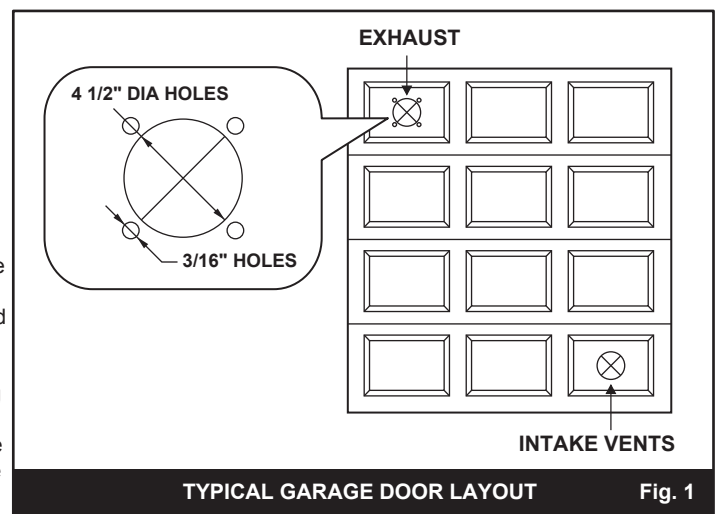

STEP 2

MOUNTING THE FANS - (Reference Fig 2A)

Use 4 Mounting Bolts (Item #7) to mount the Fan as shown in Fig. 2A.

Note! - Be sure to arrange the fan so that the air flow is directed toward the outside of the garage. An arrow is marked on the side of the fan frame to indicate the air flow direction.

Once the Fan is correctly in place, place the Finger Guard (Item #2) over the mounting bolts. Use the Wing Nuts (Item #8) to secure the fan and finger guards.

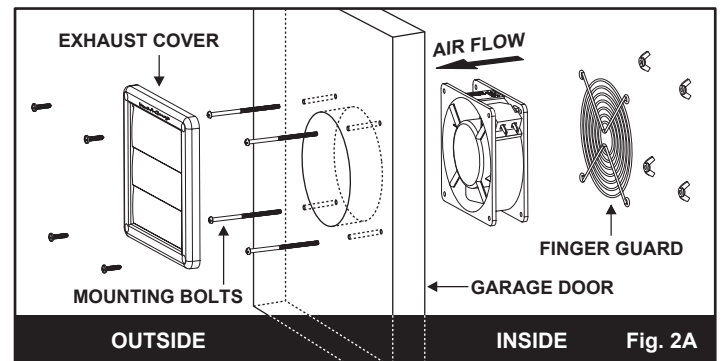

STEP 3

Install the Exterior Covers (Reference Fig. 2A & Fig.2B)

1. Place the Exhaust Cover (Item #3) over the upper vent hole cut in the door with the Vent A Garage name oriented at the top. The circular lip on the back side of the cover will fit inside the cut hole. Align the cover so that it is parallel to the side of the door.

2. Fasten the cover to the door surface with 4 Self-Drilling Mounting Screws A (Item #6). The screw will automatically pilot the holes since the tips are self-drilling. It is recommended to hand tighten the screw until snug. **DO NOT OVER-TIGHTEN** or the screw will strip the hole and lose grip.

3. Place the Intake Covers (Item #4) over the bottom vent holes and secure in place. The same procedure is to be followed to fasten the Intake Cover as described above using Self-Drilling Mounting Screws A (Item #6).

4. Finger Guard (Item #2) is provided to cover the inside of the intake vent hole with Mounting Screw B (Item #21).

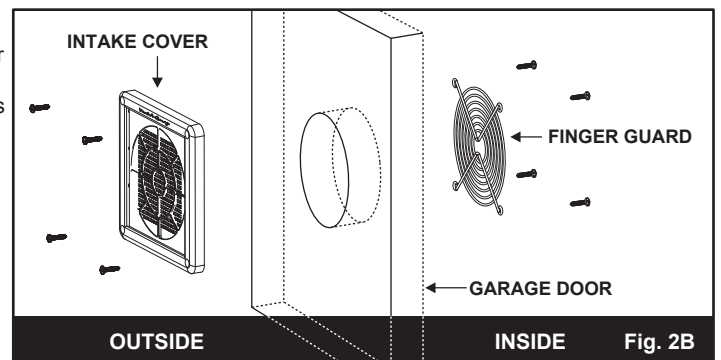

Winter Weather - If the Vent A Garage System is used in climates with cold winter weather, it may be desirable to cover the Intake Cover to block cold air and wind from entering the garage. Intake Air Blocker (Item #5) can replace the Screen in the Intake Cover for this purpose. (Fig 2C) Save the Screen in a convenient location so it can be reinstalled in the spring season.

Owner's Instructions

Vent-A-Garage System

Model No. : VG100

CAUTION: Read all instructions and warnings before operating!
SAVE THESE INSTRUCTIONS! READ ALL INSTRUCTIONS!



STEP 4

Mounting the Retractable Cord Reel (Reference Fig.3 & Fig.4)

Caution! - Do Not Connect Cord Reel to power until all assembly steps are completed.

Important! The retractable reel should be positioned adjacent to the garage door opener motor. There are two methods to mount the reel depending on how your electric garage door opener is positioned.

Ceiling Mount Option (Fig.3). - Can be utilized in most applications.

1. Assemble "C" Bracket (Item #15) to "L" Bracket (Item #19) with Bolts (Item #16), Lock Washers (Item #18) and Nuts (Item #20) as shown in Fig 3. Tighten fully to compress lock washers.
2. Locate a ceiling joist within 2 ft. to either side of the Garage Door Opener Motor, which also allows connection of the cord reel power cord to the outlet.
3. Mount the Bracket assembly as Shown in Fig. 3 to the ceiling of the garage with the use of L Bracket Screws (Item #20). The holes should be first piloted with the use of a 1/8" drill bit.
Note: The L Bracket can be positioned, perpendicular or parallel to the garage door, depending on the direction of the ceiling joist. The Bracket Assembly allows 180°rotation, the reel will line up with the cord pull direction.
4. Mount the Retractable Reel in the C Bracket as shown in Fig. 3 with Lock Pin (Item #14).

Motor Bracket Mounting Option (Fig. 4)

Note - If your Garage Door Opener Motor is suspended from the ceiling with angle iron serving as a motor bracket, as shown in Fig. 4. It may be more convenient to mount the retractable reel to the angle iron as follows:

1. Choose the side of the garage Door Opener Motor to allow connection of power cord to the outlet.
2. Connect C Bracket (Item #15) to the angle iron motor mount with the use of Bolts (Item #16) , Lock Washers (Item #18) and Nuts (Item #17). Tighten fully to compress lock washers.
3. Mount the Retractable Reel in the C Bracket as shown in Fig. 4 with Lock Pin (Item #14).

STEP 5

MOUNTING THE THERMOSTAT CONTROL BOX (Reference Fig. 5 & Fig. 6)

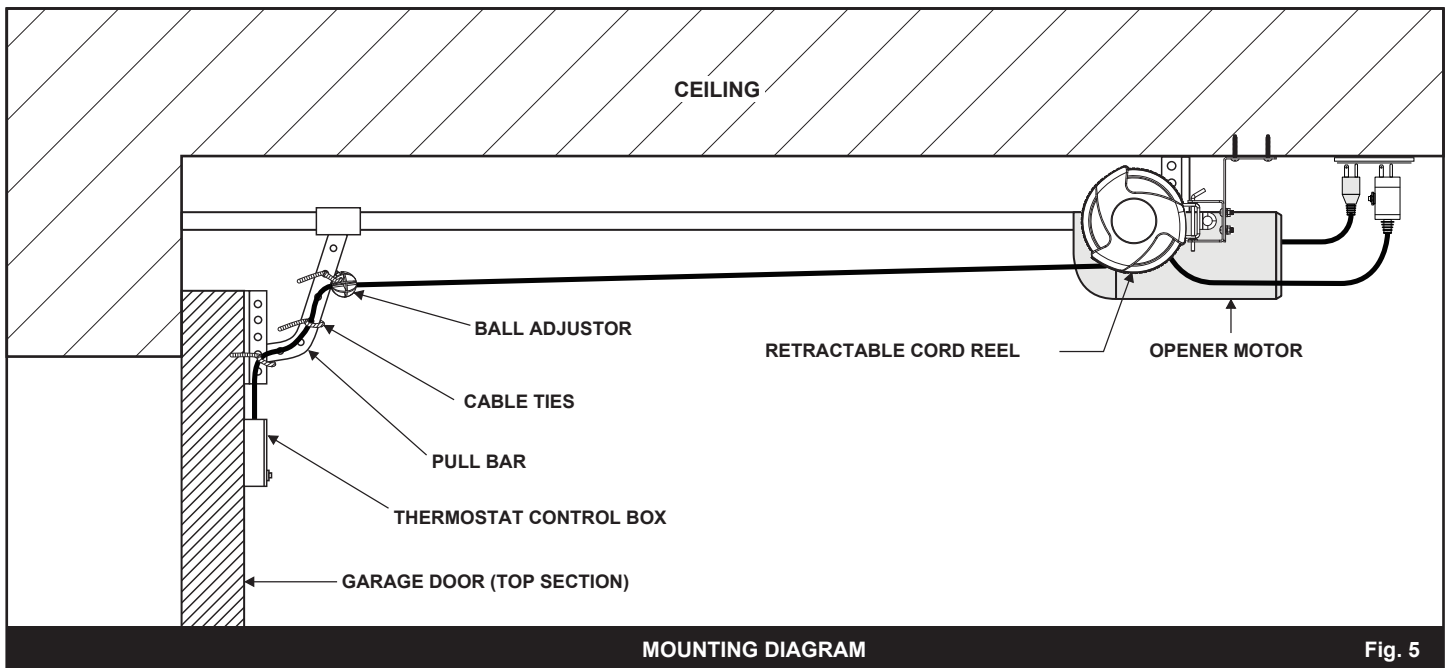
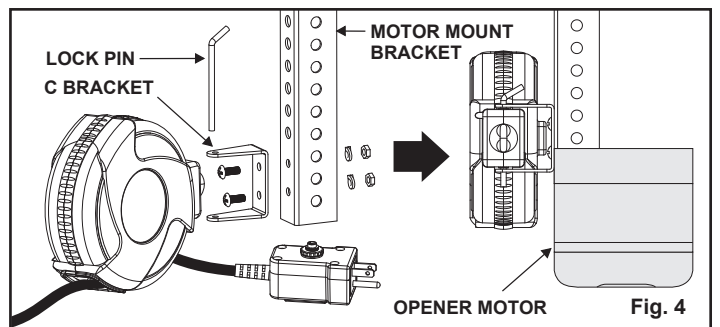
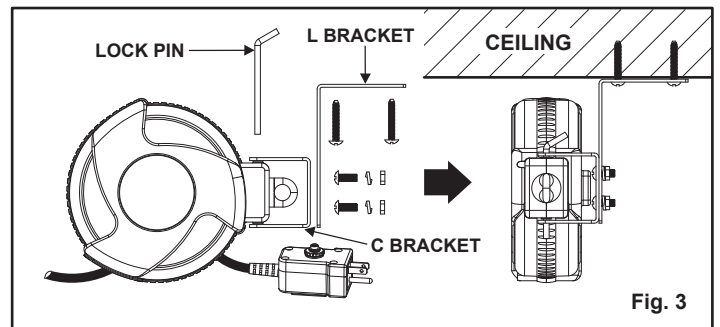
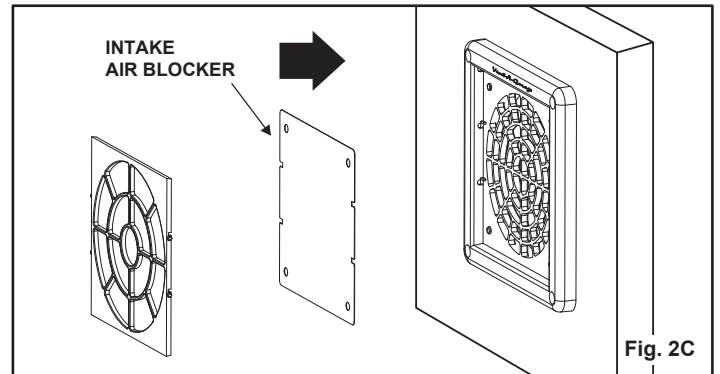

Owner's Instructions

Vent-A-Garage System

Model No. : VG100

CAUTION: Read all instructions and warnings before operating!
SAVE THESE INSTRUCTIONS! READ ALL INSTRUCTIONS!



1. Extend the cord from the reel and mount the Thermostat Control Box (Item #10) against the inside surface of the garage door.
2. The Thermostat Control Box should be located approximately in the center, top section of the garage door using 2 ea of Self-Drilling Mounting Screw A (Item #6) . It is acceptable if the Thermostat Control Box is mounted a few inches to the left or right of center of the garage door. Some garage doors may have some braces or brackets in the way of direct center.
3. Slide the black ball adjustor to all just enough slack to allow it to be attached to the pull bar. Lace a Cable Tie (Item #11) through the hole in the ball adjustor. Then attach it to a hole in the pull bar. A second cable tie can be used to attach slack wire to the pull bar in a second location.

STEP 6

CONNECTING THE FANS - (Reference Fig. 6)

1. Unwrap the additional parallel cord that comes from the Thermostat Control Box.
2. Connect the female receptacle on the end of parallel cord to the fan plug located on the side of the fan frame. (See inset illustration Fig. 6)
3. The excess cord can be wrapped around the fan frame. The wire between the Thermostat Control Box and the fan can be secured against the door with the use of the Nylon Wire Clips (Item #12) and the Self-Drilling Mounting Screw B(Item #21). The extra Cable Ties can also be utilized to gather and tie up excess cable.
4. Plug the cord reel into the 120V outlet.

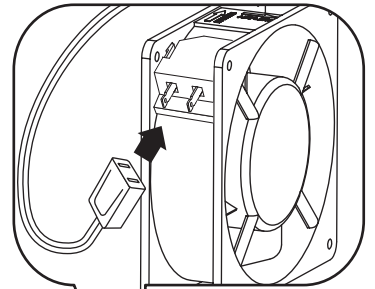

STEP 7

TESTING THE VENT A GARAGE SYSTEM

1. Garage Door Operation - Test the Garage Door down and up to check for any binding, rubbing or catching of the cord from the reel. The cord from the reel should retract and extend smoothly. If any interference is found, the reel position may need to be adjusted.
2. Push the Switch of the front of the Thermostat Control Box. When the switch is illuminated the power is on and connected properly. Turn the control knob on the Thermostat Control Box counter-clockwise or to its lowest setting, or until fan turn on. The louvers on the outside of the garage door should open up during fan operation as shown in Fig.7
Note! - If the louvers do not open when a fan is running, the fan is installed backward. The fan should be turned and remounted.
Note!- During cold weather, when the garage door may be open for of long periods, or during absence form the home for periods of time. It is recommended to turn the switch to the off position.
3. Once the fans tested and operating properly, the thermostat can be adjusted to the temperature at which the fan will turn off. This will be normally at night when the temperature falls. It is acceptable to have the fan in operation all the time, especially in warm climates where night time temperature are not much different from day time temperature.

NOTE! - OVERLOAD PROTECTION - This system is protected by a resettable circuit breaker. It is located on the male plug of the power cord from the cord reel. The circuit breaker should never trip under normal operation. However, should the system load exceed 5 amps, the circuit breaker will trip causing the reset button on the plug to pop out. Check the cord, fan and connection to make sure no damage is observed. Once the system is checked and found to be undamaged, the power can be restored by pushing the reset button.

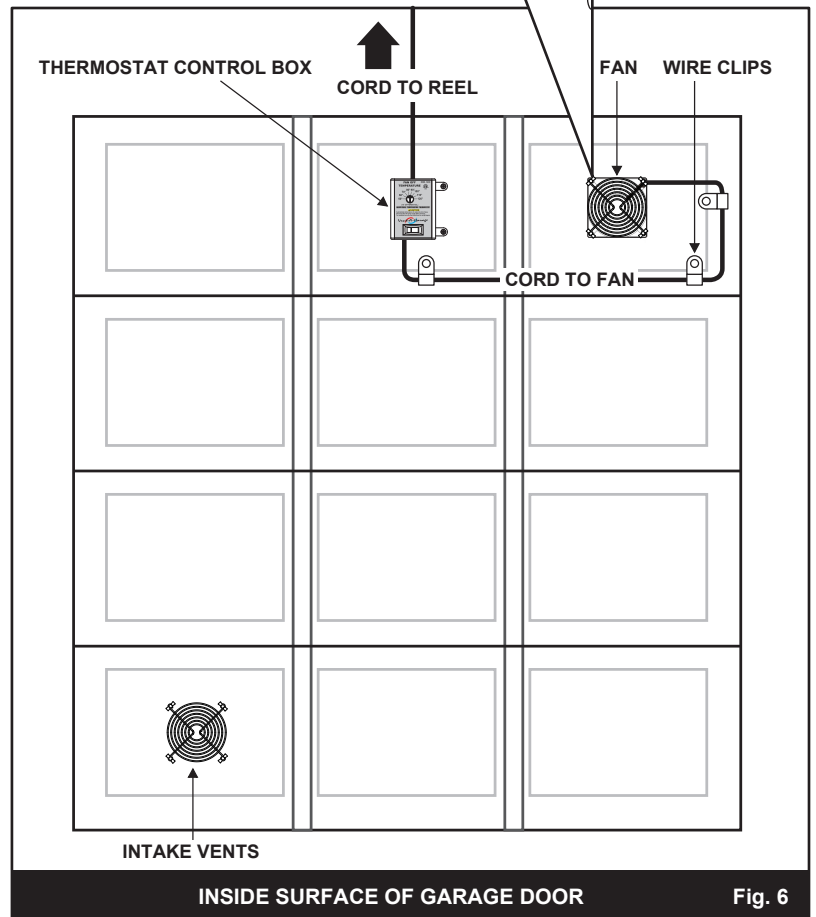

Fig. 6

REPLACEMENT PARTS

Model	Description	Cost	Send Check or money order to Alert Parts Department 24500 Solon Rd. Bedford heights, Oh 44146 Credit Card Orders Call- 1-800-400-5020
FM-1	Fan	\$22.00 each	
EC-1	Exhaust Cover	\$10.00 each	
NC-2	Intake Cover	\$9.50 each	

Owner's Instructions

Vent-A-Garage System

Model No. : VG100

CAUTION: Read all instructions and warnings before operating!
SAVE THESE INSTRUCTIONS! READ ALL INSTRUCTIONS!



MAINTENANCE

WARNING! Unplug the cord reel from the outlet before attempting any maintenance.

There is some minor maintenance required for the Vent A Garage System.

1. A soft cloth with some mild cleaner or plain soap and water should be used to remove dirt and grime as soon as it accumulates on cord, fan and vent surface.
2. The Louvers in the Exhaust Cover can be opened by hand and gently wiped clean when dirt accumulates. (See Fig. 7)
3. The Intake Cover Screen should be checked and clean periodically for dirt, dust or other debris is observed to accumulate. (See Fig. 8) Gently pry the Screen Retainer off of the Intake Cover. Remove the Screen and clean it by running under some clear water. Re-assemble the Screen and Retainer if the reverse manner in which it was removed.

Note - Replace the Screen Retainer in the same position in which it was removed. It will only fit one way back into the Cover Frame.

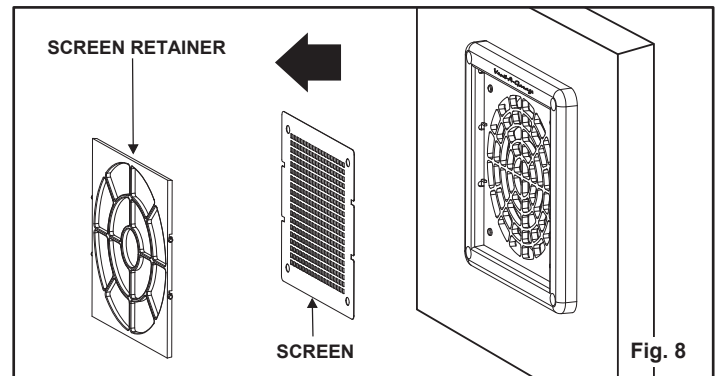
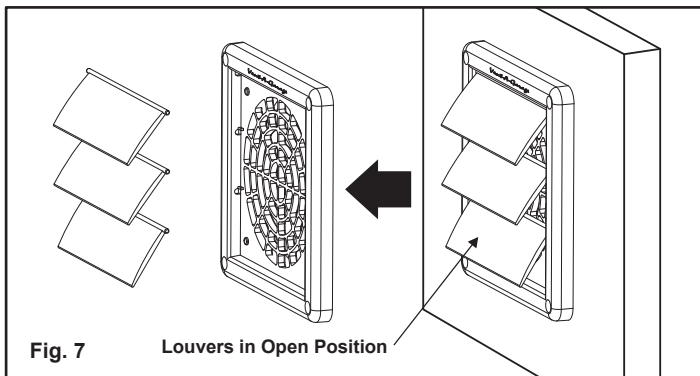

Full Three Year Warranty

All Alert products are individually tested and inspected for defects in material and workmanship before leaving the factory. Should your Alert product ever fail due to faulty workmanship or material, simply return it to the original place of purchase for a replacement. Our Three Year Return Policy is limited to the replacement of the original purchase. No other liability, responsibility or warranty is expressed or implied including any regarding merchantability or fitness for a particular purpose.

Alert Stamping & Mfg. Co., Inc.
24500 Solon Road
Bedford Heights, Ohio 44146

Web: www.alertstamping.com

Email: info@alertstamping.com